

REFER TO SHEET 1 (COVER SHEET) FOR ALL BUILDING INFORMATION REGARDING:

- SUSTAINABILITY REQUIREMENTS
- SITE CLASSIFICATION
- GENERAL BUILDING INFORMATION

CDP CHARGED DOWNPIPE DIRECTED TO TANK
SDP STANDARD DOWNPIPE DIRECTED TO STORMWATER DISCHARGE

ALL MECHANICAL VENTILATION TO BE DISCHARGED TO OUTDOOR AIR AS PER NCC REQUIREMENTS

FIRE RESISTANT PLASTERBOARD TO BE INSTALLED BEHIND COOKTOP

ALL EXTERIOR STEPS AND LANDINGS BY OWNER UNLESS NOTED OTHERWISE

ALL GROUND FLOOR BULKHEAD AND SQUARE SET OPENING FRAMES TO BE 2155 ABOVE FFL UNLESS NOTED OTHERWISE

REFER TO WINDOW & DOOR SCHEDULES FOR FULL DETAILS OF ALL WINDOWS AND DOORS

FINAL WINDOW AND EXTERIOR DOOR LOCATIONS MAY BE ADJUSTED ON SITE TO SUIT BRICKWORK GAUGE

UNLESS NOTED OTHERWISE ALL ROOMS ARE REFERENCED AS FOLLOWS:

FLOOR PLAN LEGEND

- HS / WS HOB SPOUT / WALL SPOUT
- FACE BRICK / COMMON BRICK
- HEBEL
- SOUND INSULATION
- AJ BRICK ARTICULATION JOINT
- 3D DENOTES DRAWER SIDE
- EXHAUST FAN
- L.B.W LOAD BEARING WALL
- THIS DOOR OPENS FIRST
- SMOKE ALARM
- # LIFT OFF HINGE
- + WATER POINT
- WP FRIDGE WATER POINT
- GAS GAS BAYONET

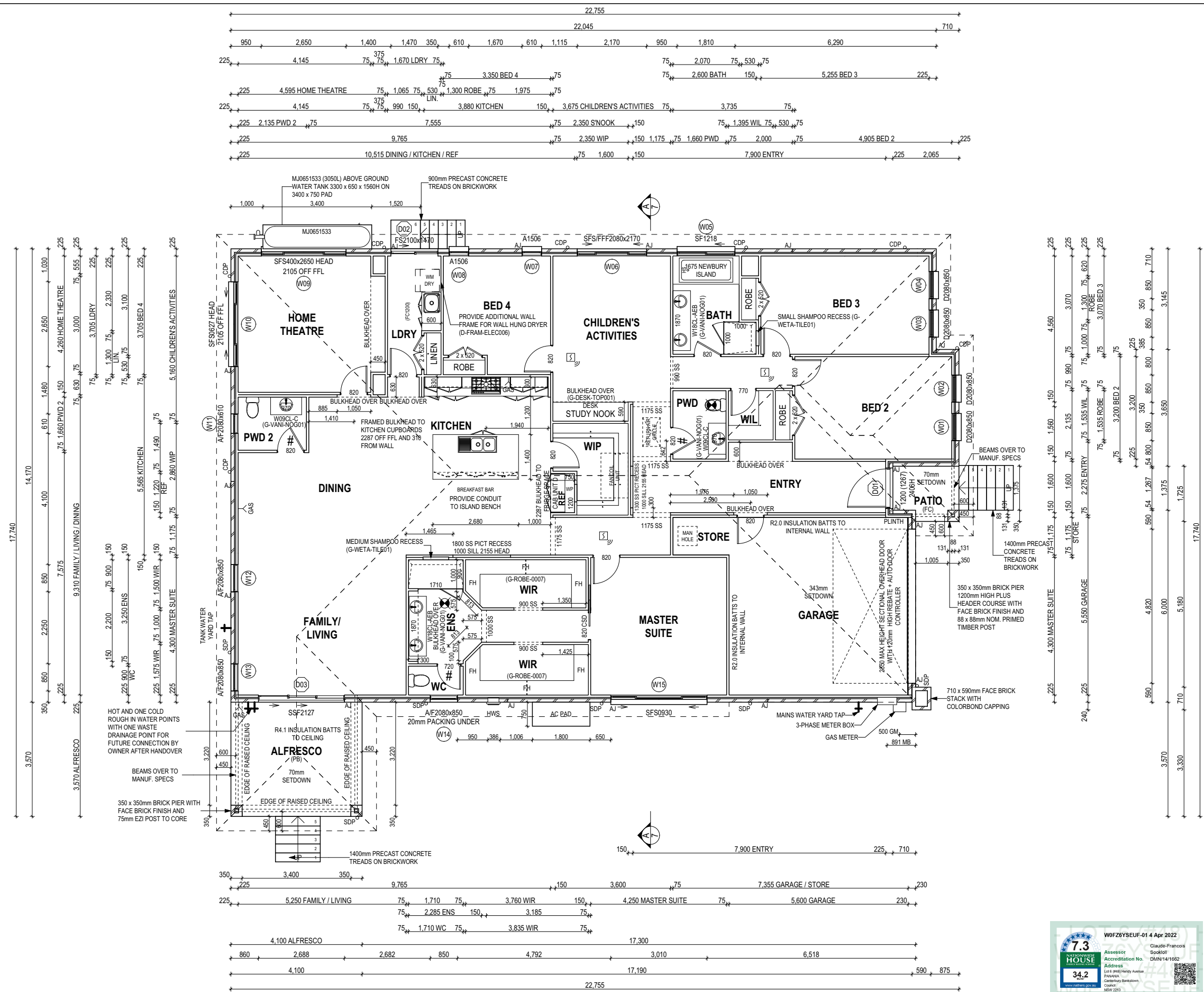

PROVIDE AND INSTALL 3 PHASE REVERSE CYCLE AIR CONDITIONING SYSTEM. NUMBER AND POSITIONING OF OUTLETS AND THE FINAL LOCATION OF THE RETURN AIR GRILLE WILL BE DETERMINED ON SITE BY THE AIR CONDITIONING CONTRACTOR AND IS SUBJECT TO TRUSS LAYOUT AND ANY OTHER CONSTRUCTION CONSTRAINTS.

FRAME MANUFACTURER TO PROVIDE CLEARANCE FOR PASSAGE OF FAN COIL UNIT FROM RETURN AIR OPENING TO FINAL FAN COIL LOCATION.

ANY PART OF THE FASCIA, GUTTERING OR DOWNPIPE THAT IS WITHIN 450mm OF ANY BOUNDARY IS TO BE NON-COMBUSTIBLE IN ACCORDANCE WITH THE NCC.

ALL EXTERIOR SLABS TO BE GRADED BY CONCRETE TO ACHIEVE APPROX. 1:100 FALL TO OUTSIDE EDGE WITH MAXIMUM CROSSFALL OF 30mm OVER ENTIRE SLAB.

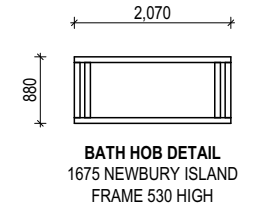

ALL DIMENSIONS ARE FRAME DIMENSIONS

© 2022 MCDONALD JONES HOMES (ABN 82 003 687 232). THIS DRAWING IS AN ORIGINAL ARTISTIC WORK WITHIN THE MEANING OF THE COPYRIGHT ACT 1968 (CTH). MCDONALD JONES HOMES IS THE OWNER OF COPYRIGHT IN THIS DRAWING. YOU HEREBY AGREE AND UNDERTAKE THAT YOU WILL NOT IN ANY WAY REPRODUCE, COPY, MODIFY, USE OR TAKE ADVANTAGE OF THE DRAWING TO BUILD A HOUSE BASED ON THIS PLAN (WHETHER IN WHOLE OR IN PART) WITHOUT THE PRIOR WRITTEN CONSENT OF MCDONALD JONES HOMES.



SPECIFICATION:	STUART EVERITT
COPYRIGHT:	© 2022

REVISION	DRAWN
5 PRELIM CONSTRUCTION PLANS	ENG 2021.07.06
6 AMEND FLOOR LEVELS	PL1 2021.12.10
7 AMENDED AS PER PCV008	CLG 2021.12.22
8 AMENDED AS PER PCV010	MDE 2022.04.04
9 SITE ANALYSIS	MDE 2022.04.04

CLIENT:	MR. JAIME JACOB & MRS. ANN RINU JACOB
ADDRESS:	48 HENDY AVENUE, PANANIA NSW 2213
LOT / SECTION / DP:	6 / - / 36587
COUNCIL:	CANTERBURY BANKSTOWN COUNCIL

HOUSE DESIGN:	SEASIDE RETREAT 16 ONE
FACADE DESIGN:	CLASSIC
SHEET TITLE:	GROUND FLOOR PLAN
SHEET No.:	5 / 18

HOUSE CODE:	H-SESCLAS13400
FACADE CODE:	F-SESCLAS01
SCALES:	1:125

DO NOT SCALE DRAWINGS. USE FIGURED DIMENSIONS ONLY. CHECK AND VERIFY DIMENSIONS AND LEVELS PRIOR TO THE COMMENCEMENT OF ANY WORK. ALL DISCREPANCIES TO BE REPORTED TO THE DRAFTING OFFICE.

606379



CONSTRUCTION DRAWING

DATE: 06/07/2021

DRAFTING OFFICE: SYDNEY

PRELIMINARY